

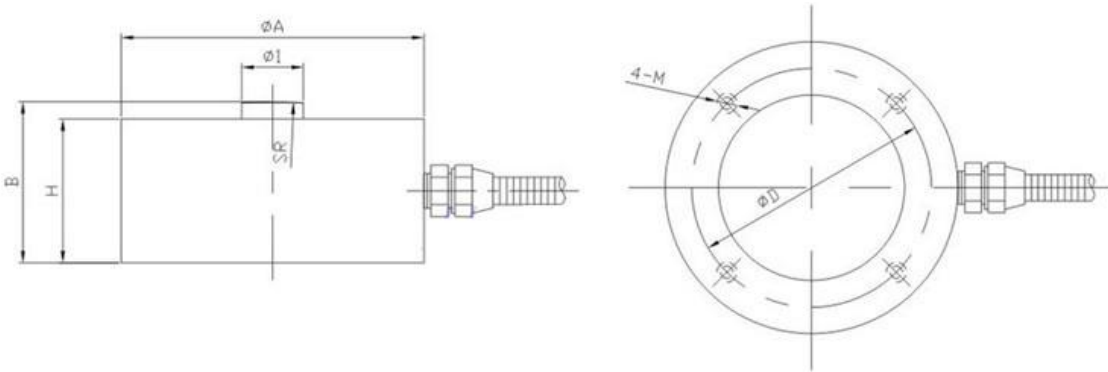

**Features:**

- ◆ Capacity : 50kg-10Ton
- ◆ Material: alloy steel
- ◆ Type: spoke type
- ◆ Defend grade: IP66.
- ◆ Application: suitable for force control in production control, vibratory feeding equipment and other electronic weighing or force measuring fields.

Electrical connection and Dimensions:(dimension unit: mm)



Cap	øA	B	H	ø1	øD	4-M	SR
50kg-5T	51	25	20	10	42	M5	SR50
6-10T	88	47	42	18	72	M6	SR150

**Specifications:**

capacity	kg	50,100,200,300,500,1000,2000,3000,5000,10,000
safe overload	%FS	150
ultimate overload	%FS	200
rated output	mV/V	1.5-2.0
excitation voltage	Vdc	5-15
combined error	%FS	±0.3
zero balance	%FS	± 1.0
non-linearity	%FS	± 0.3
hysteresis	%FS	± 0.3
repeatability	%FS	± 0.3
creep	%FS/30min	± 0.1
input resistance	Ω	350 ± 50
output resistance	Ω	350 ± 5
insulation resistance	M Ω	≥ 2000
operating temperature range	°C	-20 ~ +65
compensated temperature range	°C	-10 ~ +40
temperature coefficient of SPAN	%FS/10°C	± 0.10
temperature coefficient of ZERO	%FS/10°C	± 0.10
Electrical connection	cable	4 core shielded PVC cable, ø3.0 × 2000 mm

※Ordering code: model-capacity- rated output-accuracy-defend grade- the length of cable